

MORMUGAO PORT TRUST
ENGINEERING MECHANICAL DEPARTMENT

Quotation no. CME/XEN(E)/PH//P-4/02



An ISO 9001 : 2008 Port
ISPS CODE Compliant

QUOTATION BASED TENDER

**FOR “Replacement of old Star/Delta starters panels by new Star/Delta group
starter panel for MM Complex Pump House, Baina”.**

Due at **3.00 P.M** on **18 .01.2018**

Website: www.mptgoa.com

MORMUGAO PORT TRUST
ENGINEERING MECHANICAL DEPARTMENT

Quotations based Tender are invited in single cover system from firms duly super scribed as

QUOTATION BASED TENDER FOR “Replacement of old Star/Delta starters panels by new Star/Delta group starter panel for MM Complex Pump House, Baina”.

Quotation invited by	CHIEF MECHANICAL ENGINEER, MORMUGAO PORT TRUST
Quotation No.	CME/XEN(E)/PH/P-4/02
Name of Work	<u>“Replacement of old Star/Delta starters panels by new Star/Delta group starter panel for MM Complex Pump House, Baina”.</u>
Document Cost	Rs.500/- in the form of DD from Nationalized/Scheduled Banks in favour of the Financial Advisor & Chief Accounts Officer, MPT, payable at Vasco, Goa to be submitted along with the quotation, otherwise the offer <i>shall not be considered.</i> (Quotation Document Fee is not refundable)
Earnest Money Deposit	2% of the contract value in the form of DD from Nationalized/Scheduled Bank.
Security Deposit	10 % of the contract value. Two parts: (i) 5% on contract value – to be furnished within 30 days of placement of order/LOA. (ii) 5% retention money deducted from the running bills.
Completion Period	The work should be completed within 90days from the date of 7 th day of receipt of LOA.
Liquidated Damages	For delay in supply/work Liquidated Damages, equivalent to 1% of the total contract value/per week or part thereof subject to maximum 10% are liable to be deducted from any money due or become due to the Contractor
Payment terms	100% payment shall be made within 30 days after satisfactory completion of work on producing invoice complete in all respect. The contractor shall furnish their bank account number PAN card, MICR number Name of the Branch along with Bill for arranging payment made through E.C.S. by the Trust.
Bid Validity	60 Days from the date of opening of the quotation.
Guarantee Period	12 months from the date of taking over of the work.
Date of submission of bids	18 /01/2018 till 15:00 Hrs.
Date of Opening of bids	18 / 01 /2018 at 15:30 Hrs
Address for communication and submission of bid:	Executive Engineer(E-HL), Mechanical Engineering Department, Mormugao Port Trust, Electrical Section, 1st Floor, Admin. Building, Headland sada Vasco-de-Gama Goa - 403804

Contact Details	Phone :0832- 2594241 Email : xene.mgpt@gmail.com
Website	<u>www.mptgoa.com</u>

CHIEF MECHANICAL ENGINEER

TECHNICAL SPECIFICATION

1.0. GENERAL

Mormugao Port Trust invites the quotation based tender in Single cover system for the work of **“Replacement of old Star/Delta starters panels by new Star/Delta group starter panel for MM Complex Pump House, Baina”.**

1. SCOPE OF WORKS:

- i. Disconnection of all incoming and outgoing cables of existing starter panels.
- ii. The old starter panel and frame has to be removed completely.
- iii. Fabrication, Supply and grouting of the M S Angle stand/frame for installation of panel.
- iv. The new panel shall be mounted on MS Angel stand with detachable gland plates and shall be painted with grey electric paint. The adequate space is to be provided for incoming and outgoing cables from the panel.
- v. Supply, installation testing and commissioning of new Start/Delta group starter panel (indoor panel) fabricated in 16SWG (1.5) CRCA sheet as per IP 65.
- vi. The panel shall be powder coated by Siemens grey PC RAL 7032.
- vii. The panel shall be indoor type as per IP 65 and will be free standing floor mounted with bottom cable entry provision.
- viii. The panel shall be totally dust & Vermin proof. The list of internal components as per the table given below.

Sr. no	Items	Qty(in No's)
a.	<u>Main Incoming Switchgear.</u> 1. 250A TP fuse unit 250A HRC fuse. 2. RYB Phase indicator Lamps 230V AC. 3. VAF Meter C1 1.0. 4. 250/5A CT, s tape wound C1 1.0 15VA. 5. 6A SP MCB 10KA. 6. Bus bar chamber consisting of 250A Aluminium bus bars RYBN.	1 set (3 no's) 1 set 1 no. 3 nos. 3 nos. 1 set
b.	Outgoing switchgear:- i) 60HP Star/Delta starter. ii) 160A TP MCCB. iii) 70A TP Power contactor. iv) 95A TP Power contactor. v) 66-110A over Load Relay. vi) Star/Delta Timer. vii) ON/OFF/TRIP I indication Lamp.(1 set 3 Lamps each) viii) Start/Stop push button. ix) 6A SP MCB 10KA. x) Cable connector.(as per sizes of cables) xi) 100A MCCB TP 25KA.	2 nos. 2 nos. 2 nos. 4 nos. 2 nos. 2 nos. 2 set. 2 set. 2 nos. 12 nos. 1 no.

c.	Cable Tray. Fabrication of GI cable trays with required accessories, GI supports as per following specification. 300x50 mm, 3 mm thick ladder type GI cable tray.	10 meters.
----	---	------------

- ix. The Panel shall be provided with proper locking arrangement. The nut/bolts shall be of GI material.
- x. The MCCB,s shall be of make Schneider/ L&T/Siemens/ABB make.
- xi. The wire shall be ISI certified multistrand copper wires of make Finolex/Havells/RPG/Uniflex make.
- xii. All the components have to be mounted in the panel as per the drawing enclosed.
- xiii. Panel shall be internally wired with Copper PVC insulated wires and connectors.
- xiv. The GI cable tray shall be of size 300X50X3 MM with required accessories and shall be properly supported with GI support brackets for cable laying.

2.0. INSTALLATION AND COMMISSIONING

Installation and commissioning should be carried out to the satisfaction of the Engineer in charge. All left over / scrap materials etc. are to be promptly cleared out from the work site by the Bidder at his own cost. Left over / scrap materials should be shifted to Power House, Baina Workshop.

3.0. GENERAL TERMS AND CONDITIONS

3.1. Validity:

The validity period for the offer shall be 60 days from the date of opening of the quotation.

3.2. Price:

i) **“The bidder shall quote the price exclusive of GST. Applicable GST shall be paid on the quoted price. The bidder shall indicate the applicable GST rate on the goods/services in the price bid.**

ii) **Evaluation will be done only on the basic price.**

3.3 Earnest Money Deposit:

- i) The BIDDER shall deposit 2% of the contract value as Earnest Money in the form of DD.
- ii) The Earnest Money Deposit of unsuccessful Bidders shall be returned on award of Contract to the successful Bidder. No interest shall be payable on the amount of EMD in any case. The Earnest Money Deposit of the successful Bidders shall be refunded only on receipt of Security Deposit.
- iii) MPT reserves right to forfeit Earnest Money Deposit in respect of successful Bidder, if he fails to furnish the necessary Security Deposit towards performance within 30 days.

3.4. Security Deposit:

i) Security deposit shall consist of two parts:

- a) The DD of 5% of the contract value rounded off to nearest 100 rupees shall be submitted within 10 days of issue of Letter of Acceptance.
- b) The balance 5% shall be recovered as Retention Money from the running bills. Thereafter, the total of 10% (DD 5% and 5% Retention Money) shall be returned after completion of Guarantee period of one year.

ii) The contractor shall furnish the Security Deposit in the form DD from Nationalized / Scheduled Banks in favour of the Financial Advisor & Chief Accounts Officer, MPT, payable at Vasco, Goa within 10 days from the date of issue of Letter of Acceptance(LOA). This Security Deposit shall be converted to Performance Guarantee during the guarantee period.

3.5. Completion Period:

The entire work shall be completed within **90days** from the 7th day of receipt of LOA/Purchase order..

3.6. Guarantee Period:

i) The Contractor shall give the guarantee for a period of **12 months** from the date of taking over of the work. Any defect observed during the guarantee period, the same shall be replaced by the Contractor, free of cost. However, The Security Deposit shall be converted to Performance Guarantee during the guarantee period.

3.7. Payment Terms:

i) 100% payment shall be made on within **30 days** after satisfactory completion of work on producing invoice complete in all respect.

ii) The contractor shall furnish their bank account details for the payment through ECS by the Trust. A copy of the PAN card, Service Tax Registration no., EPF& ESI shall be furnished. MICR number Name of the Branch along with Bill for arranging payment made through E.C.S. by the Trust.

3.8. Liquidated Damages:

In the event of failure by the contractor to complete the execution of the work within the time stipulated in the contract or by the expiry of any period of extension granted by the Board's terms thereof, the contractor shall pay the Board as Liquidated Damages for delay to complete the work, a sum of 1% of contract price per week or part thereof subject to a maximum of 10% and the Board shall have the power to deduct this amount from the payment of the amounts due to the contractor or from his deposit.

3.9. Other terms and conditions

- i)** All tools and tackles and logistics involved in the work shall be arranged by the Contractor at their own cost.
- ii)** The Bidders is advised to visit the site and get acquainted regarding the nature of the work involved at site conditions before quoting the rate.
- iii)** The scope of work and bill of quantities at “**ANNEXURE-1**” to be read in conjunction to ensure the actual supply and works involved.
- iv)** Necessary Entry passes shall be obtained by the Contractor at their own cost with the approval of Port Officials.
- v)** The Trust will not be responsible for any loss or damage of the men/materials/ tools/plants engaged by the firm during the work at site or transportation.
- vi)** The Contractor shall take utmost care during the execution of the work, if any damage to Port property, the cost of the damage shall be deducted from the Contractor’s bill.
- vii)** The power supply shall be provided by the Port on free of cost for execution of the work; however, the Contractor shall take power supply from the nearest source by their own arrangement.
- viii)** Address for communication and submission of bid: Superintending Engineer (E-HL), Engineering Mechanical Department, Mormugao Port Trust. Administrative Office, Mormugao Goa 403802. Contact no: 0832-2594205, 0832-2594241.
- ix)** Further amendments if any, visit our Website www.mptgoa.com

CHIEF MECHANICAL ENGINEER

ANNEXURE-1

BILL OF QUANTITIES

SR. NO	DESCRIPTION	Unit	QUANTITY	Unit Rate (Rs)		Amount (Rs)	GST (%)
				In fig.	In words		
1	Removal of existing Star/Delta panels, stand etc. Supply, Installation, Testing & Commissioning of Star/Delta group starter panel as per the technical specification detailed given in the Scope of Work.	No.	1				
2.	<u>Cable Tray.</u> Fabrication of GI cable trays (as per specification 300x50mm, 3mm thick ladder type GI cable tray) with required accessories & GI supports.	Meters	10				
			TOTAL		Rs.		

(In Words Rupees-----only).

Date:

Signature:

Place:

Name:

Address:

Office seal of firm:

Note: 1. The bidder shall quote the price exclusive of GST. Applicable GST shall be paid on the quoted price. The bidder shall indicate the applicable GST rate on the goods/services in the price bid.

2. Evaluation will be done only on the basic price.

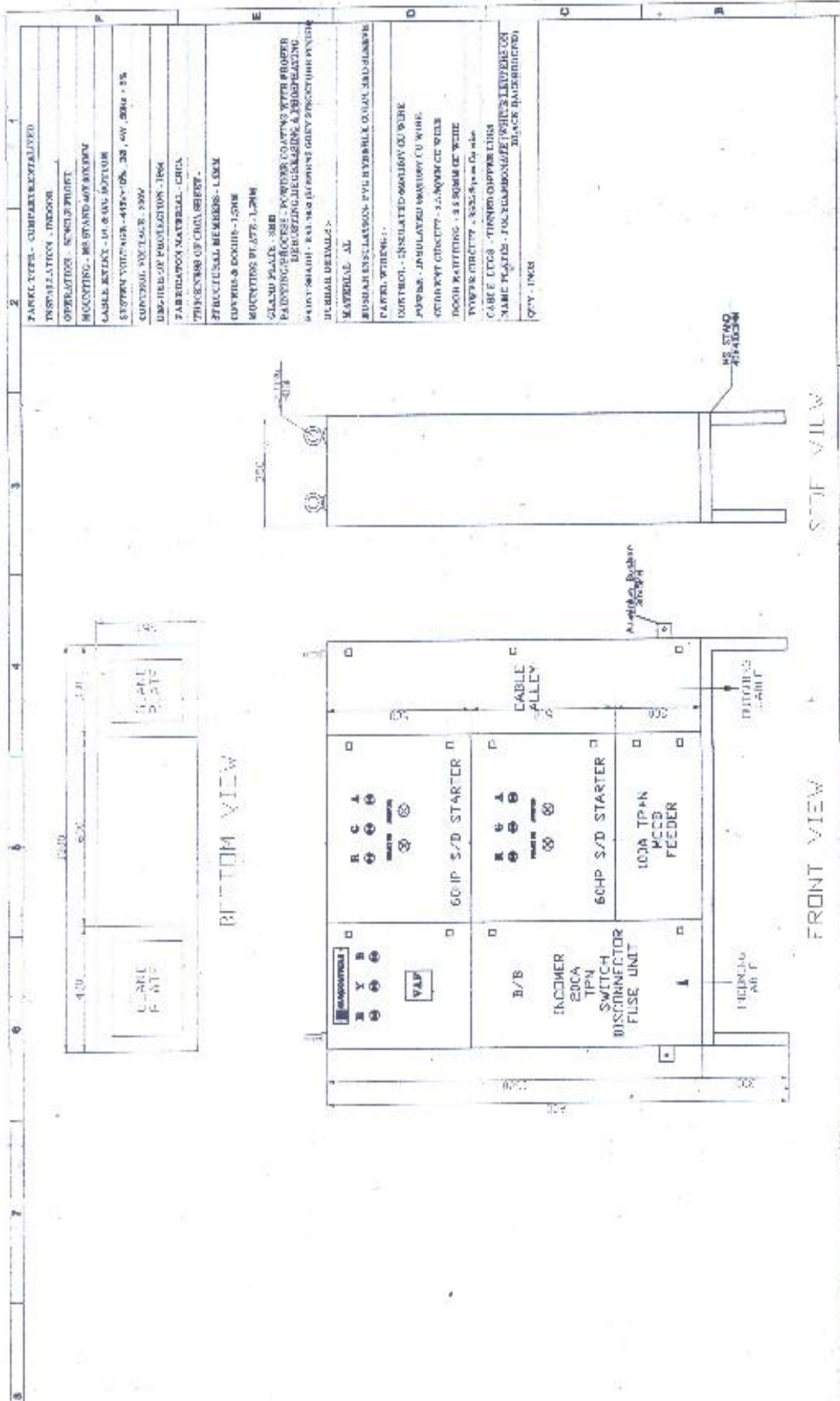

MATERIALS LIST

1	PANEL TYPE - CURB MOUNTED/INDOOR
2	INSULATION - INSIDE
3	OPERATING - 200A TPN SWITCH
4	MOUNTING - MS STAND OFF/STAND
5	CABLE TRAY - 10 @ 1000
6	STEEL PLATE - 4130 - 1/2" THK - 30' LW - 20" H - 15'
7	CABLE TRAY - 1000
8	USE OF PROTECTION - 1000
9	FABRICATION MATERIAL - CHINA
10	THICKNESS OF CHINA SHEET -
11	STRUCTURAL MEMBERS - 1000
12	CUTTING & BENDING - 1000
13	MOUNTING PLATE - 1000
14	GLASS PLATE - 3000
15	PAINTING/POSSIBLE - POWDER COATING WITH PROPER UNDERCOATING & REPRIMING
16	WARRANTY - 3000
17	USUAL DETAILS -
18	MATERIAL - AL
19	SUSPENSION/CLAMP - POLYESTER/ALUMINUM/STAINLESS
20	PAINT/WHITENESS -
21	CONTROL - INSULATED/INSULATED/INSULATED
22	WIRE - INSULATED/INSULATED/INSULATED/INSULATED
23	CONDUIT - INSULATED/INSULATED/INSULATED/INSULATED
24	TERMINAL BLOCK - 1000
25	TERMINAL BLOCK - 1000
26	TERMINAL BLOCK - 1000
27	TERMINAL BLOCK - 1000
28	TERMINAL BLOCK - 1000
29	TERMINAL BLOCK - 1000
30	TERMINAL BLOCK - 1000
31	TERMINAL BLOCK - 1000
32	TERMINAL BLOCK - 1000
33	TERMINAL BLOCK - 1000
34	TERMINAL BLOCK - 1000
35	TERMINAL BLOCK - 1000
36	TERMINAL BLOCK - 1000
37	TERMINAL BLOCK - 1000
38	TERMINAL BLOCK - 1000
39	TERMINAL BLOCK - 1000
40	TERMINAL BLOCK - 1000
41	TERMINAL BLOCK - 1000
42	TERMINAL BLOCK - 1000
43	TERMINAL BLOCK - 1000
44	TERMINAL BLOCK - 1000
45	TERMINAL BLOCK - 1000
46	TERMINAL BLOCK - 1000
47	TERMINAL BLOCK - 1000
48	TERMINAL BLOCK - 1000
49	TERMINAL BLOCK - 1000
50	TERMINAL BLOCK - 1000
51	TERMINAL BLOCK - 1000
52	TERMINAL BLOCK - 1000
53	TERMINAL BLOCK - 1000
54	TERMINAL BLOCK - 1000
55	TERMINAL BLOCK - 1000
56	TERMINAL BLOCK - 1000
57	TERMINAL BLOCK - 1000
58	TERMINAL BLOCK - 1000
59	TERMINAL BLOCK - 1000
60	TERMINAL BLOCK - 1000
61	TERMINAL BLOCK - 1000
62	TERMINAL BLOCK - 1000
63	TERMINAL BLOCK - 1000
64	TERMINAL BLOCK - 1000
65	TERMINAL BLOCK - 1000
66	TERMINAL BLOCK - 1000
67	TERMINAL BLOCK - 1000
68	TERMINAL BLOCK - 1000
69	TERMINAL BLOCK - 1000
70	TERMINAL BLOCK - 1000
71	TERMINAL BLOCK - 1000
72	TERMINAL BLOCK - 1000
73	TERMINAL BLOCK - 1000
74	TERMINAL BLOCK - 1000
75	TERMINAL BLOCK - 1000
76	TERMINAL BLOCK - 1000
77	TERMINAL BLOCK - 1000
78	TERMINAL BLOCK - 1000
79	TERMINAL BLOCK - 1000
80	TERMINAL BLOCK - 1000
81	TERMINAL BLOCK - 1000
82	TERMINAL BLOCK - 1000
83	TERMINAL BLOCK - 1000
84	TERMINAL BLOCK - 1000
85	TERMINAL BLOCK - 1000
86	TERMINAL BLOCK - 1000
87	TERMINAL BLOCK - 1000
88	TERMINAL BLOCK - 1000
89	TERMINAL BLOCK - 1000
90	TERMINAL BLOCK - 1000
91	TERMINAL BLOCK - 1000
92	TERMINAL BLOCK - 1000
93	TERMINAL BLOCK - 1000
94	TERMINAL BLOCK - 1000
95	TERMINAL BLOCK - 1000
96	TERMINAL BLOCK - 1000
97	TERMINAL BLOCK - 1000
98	TERMINAL BLOCK - 1000
99	TERMINAL BLOCK - 1000
100	TERMINAL BLOCK - 1000

BOTTOM VIEW

FRONT VIEW

SIDE VIEW