

SCHEDULE - I

FACILITIES PROPOSED TO BE PROVIDED IN FISHERY HARBOUR:-

	PLINTH AREA
1. SECURITY	27.24 sq.m
2. OFFICE & RADIO COMMUNICATION	181.64 sq.m
3. AUCTION HALL - 3 Nos. (80m x 12m)	2880.00 sq.m
4. TOILET - 2 Nos	135.46 sq.m
5. CANTEEN /RESTAURANT	127.70 sq.m
6. REST SHED - 2 Nos.	426.80 sq.m
7. NET MENDING SHED	206.95 sq.m
8. GEAR SHED - 2 Nos.	322.60 sq.m
9. WORKSHOP	95.34 sq.m
10. PETROL PUMP - 2 Nos.	150.00 sq.m
11. SUMP/OVER HEAD WATER TANK	100.00 cum
12. ELECTRICAL SUB-STATION	
13. EFFLUENT TREATMENT PLANT (ETP)	500.00 sq.m

SCHEDULE - II

PROPOSED DEVELOPMENT AREA FOR FISHERY HARBOUR:-

1. BACK UP AREA	-	27360 sq.m
2. JETTY AREA	-	2560 sq.m
3. SLIP WAY	-	1500 sq.m
4. AREA NEAR APPROACH	-	3580 sq.m
TOTAL AREA	-	35000 sq.m (Approx.)

SCHEDULE - III

PROPOSED AREA FOR REHABILITATION:-

1. Area - 1	-	8840 sq.m
2. Area - 2	-	8760 sq.m
3. Area - 3	-	2300 sq.m
TOTAL AREA	-	19900 sq.m (approx.)

SCHEDULE - IV

FACILITIES PROPOSED TO BE PROVIDED FOR TRADITIONAL FISHERMEN AT KHAREWADA:-

14. OFFICE AND RADIO COMMUNICATION	-	100.00 sq.m
15. TOILET	-	34.29 sq.m
16. NET MENDING SHED (2 NOS)	-	206.95 sq.m
17. RAMP - 2 NOS	-	836.00 sqm

CONCEPTUAL PLAN OF VASCO BAY DEVELOPMENT

TIDE LEVELS

HHW	(+) 2.30m
MHHW	(+) 1.90m
MLHW	(+) 1.80m
MHLW	(+) 1.00m
MLLW	(+) 0.50m
MSL	(+) 1.30m

** ALL LEVELS w.r.t CHART DATUM

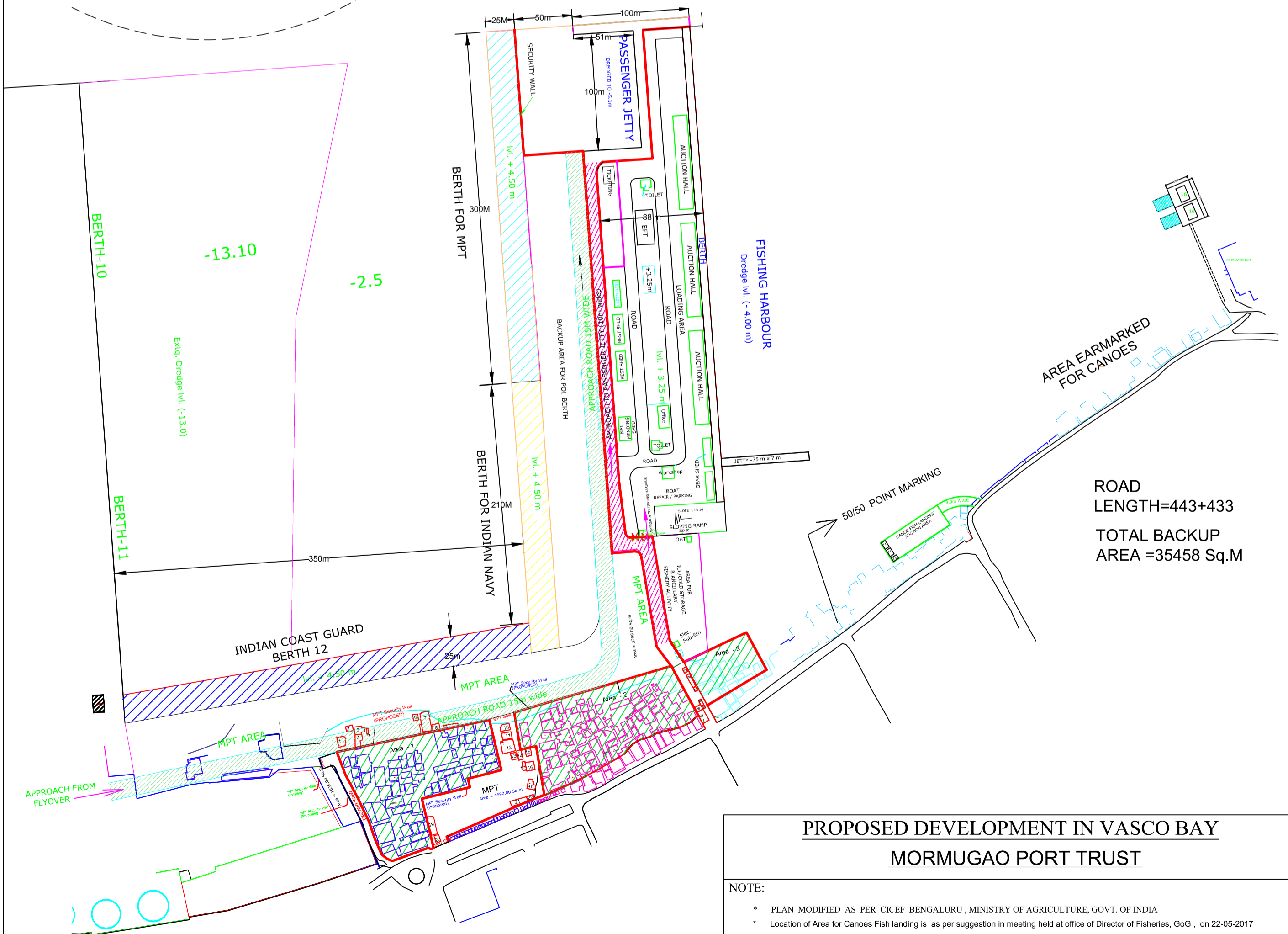

**PROPOSED DEVELOPMENT IN VASCO BAY
MORMUGAO PORT TRUST**

NOTE:

- * PLAN MODIFIED AS PER CICEF BENGALURU, MINISTRY OF AGRICULTURE, GOVT. OF INDIA
- * Location of Area for Canoes Fish landing is as per suggestion in meeting held at office of Director of Fisheries, GoG, on 22-05-2017

SCALE - 1:2500